

This bulletin covers the following Champion Power Equipment models (*Note: Read instructions completely before performing service*):

- **All Champion Power Equipment products equipped with a 717cc Gasoline powered engine**

Instructions to change out jets for Operation at High Altitude

1. Unlock fasteners (1) by rotating them 90 degrees to counter-clock wise. Remove air cleaner cover (2) by pulling it forward.

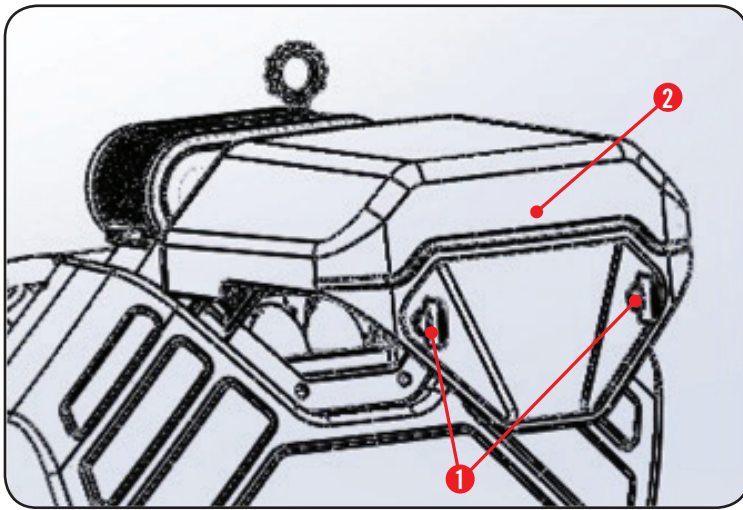

2. Remove air cleaner (3).

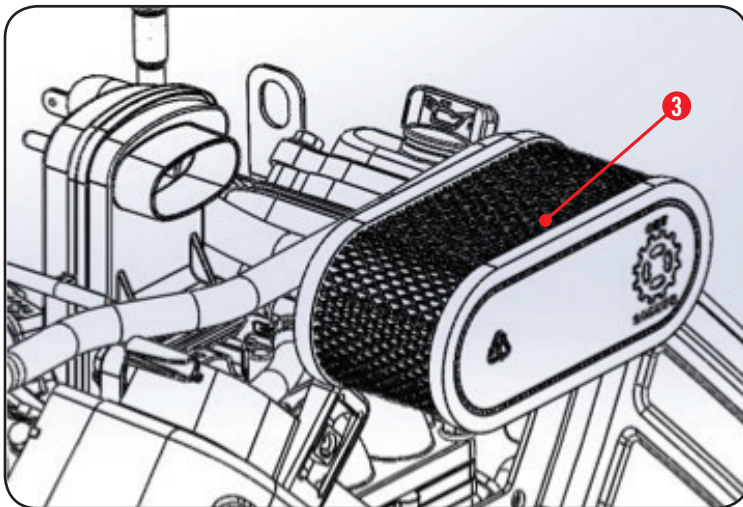

3. Loosen fuel hose clamp (4) and remove fuel hose (5). Loosen breather tube clamp (6) and then remove breather tube (7).

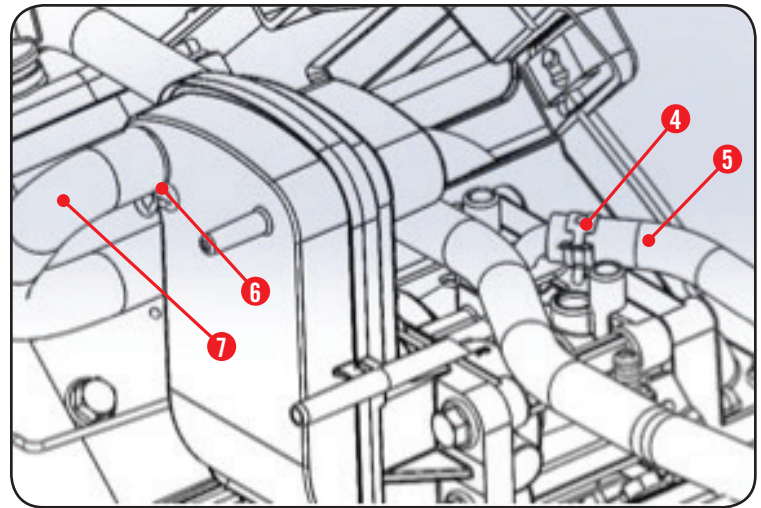

4. Disconnect taking up spring (9) then remove governor link (8) and from carburetor throttle lever.

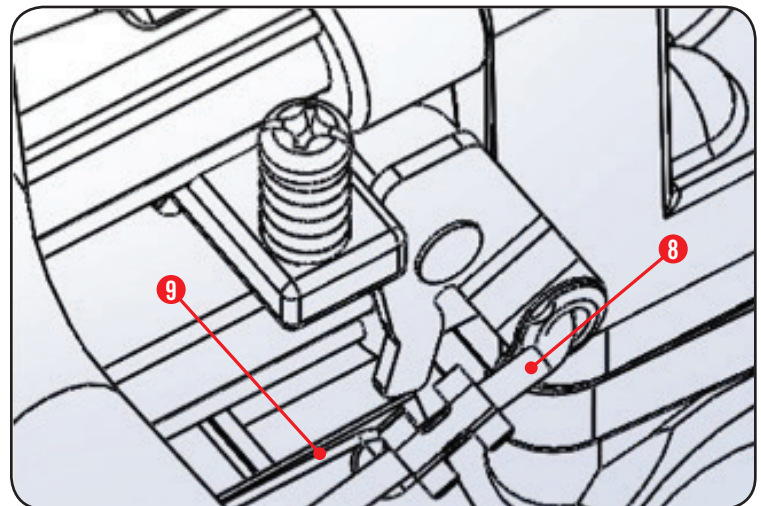

(Continued on page 2)

Operation at High Altitude Jet

5. Disconnect choke link (10) from control arm by pulling up on retaining clip (11), and then remove choke link from carburetor choke lever.

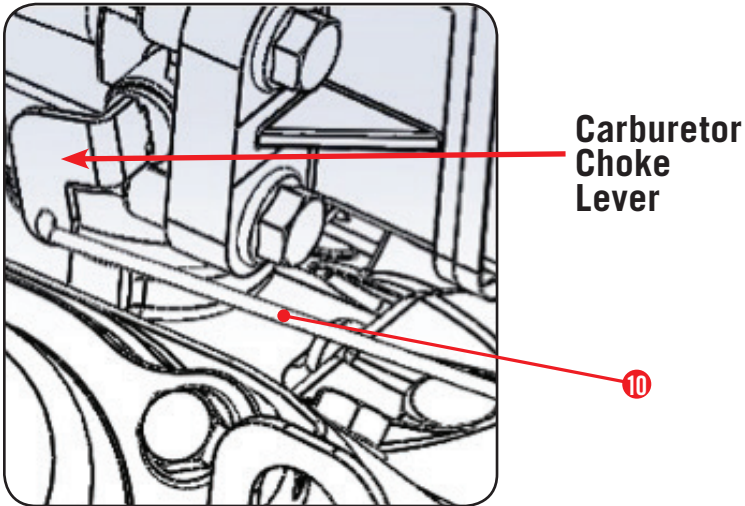
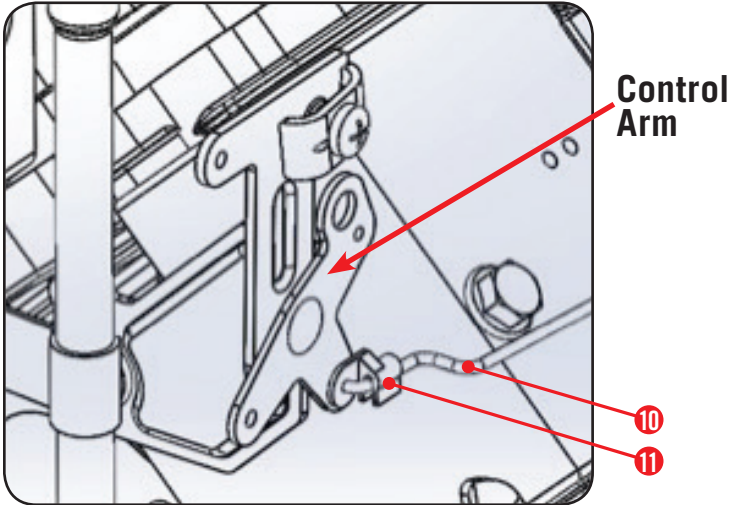

6. Disconnect wire harness connector (12) from carburetor fuel cut solenoid.

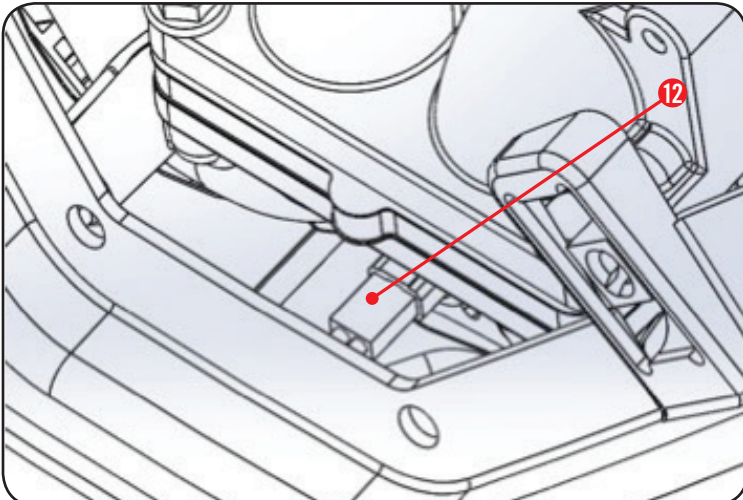

7. Remove bolts (13). Slide back air cleaner elbow (14), gasket (15) and carburetor (16).

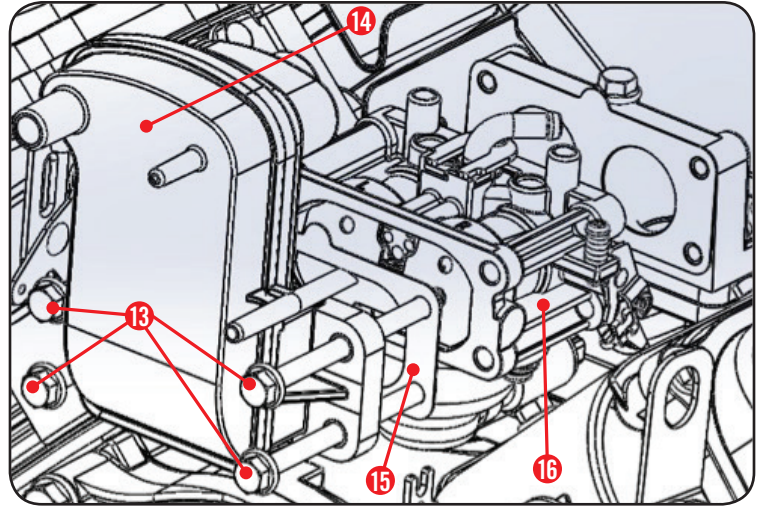

8. Remove float bowl screws (17). Lift float bowl (18) straight away from carburetor body.

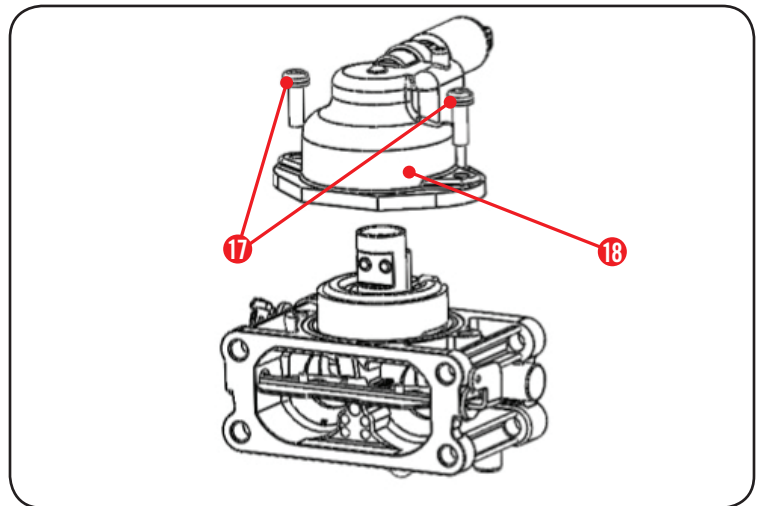

Operation at High Altitude Jet

9. Remove float assembly (18) and O-Ring (21) from carburetor body.

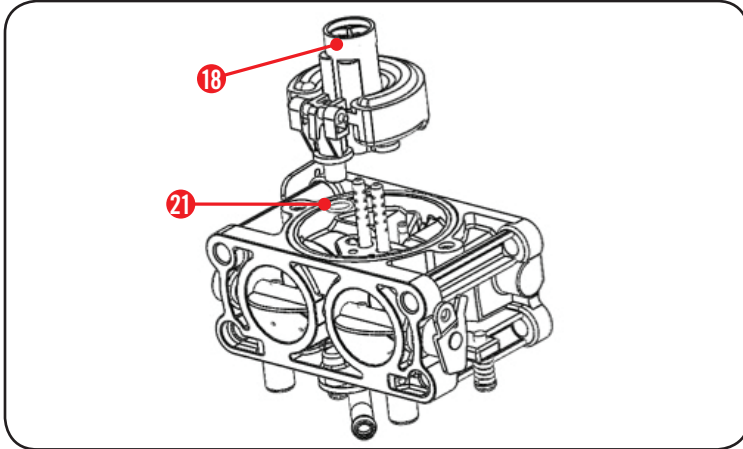

10. Remove O-Ring (22) from float assembly (18).

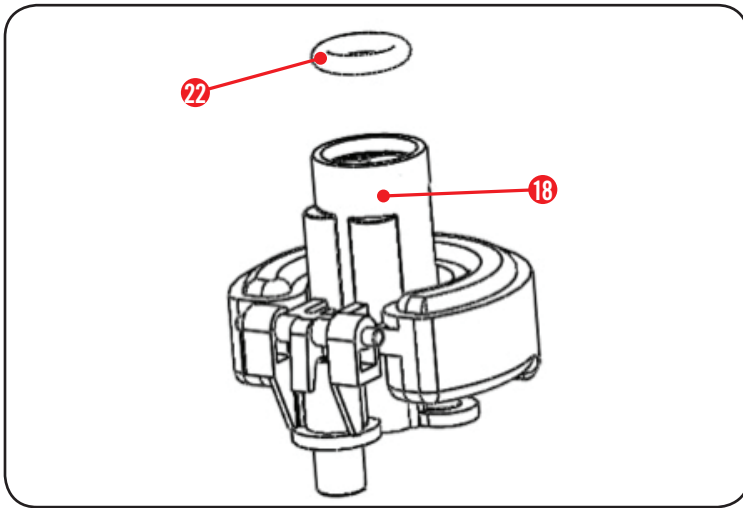

11. Remove main jet assemblies (23) by pushing them out from top side of the float assembly (18) using a suitable rod such as 1/8" pin punch for jet removal.

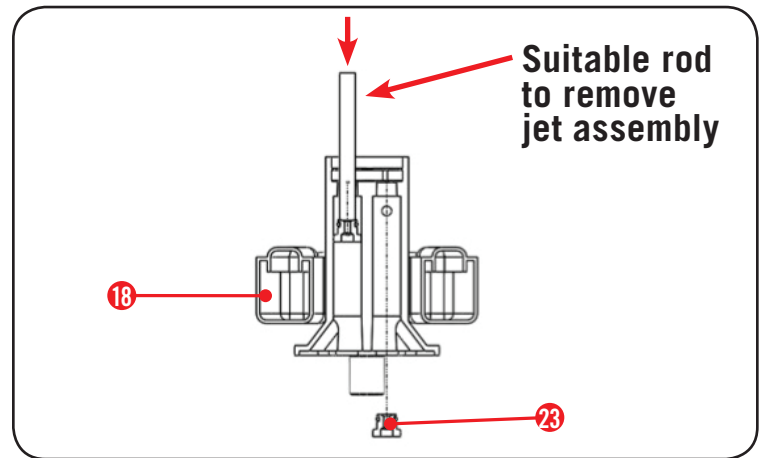
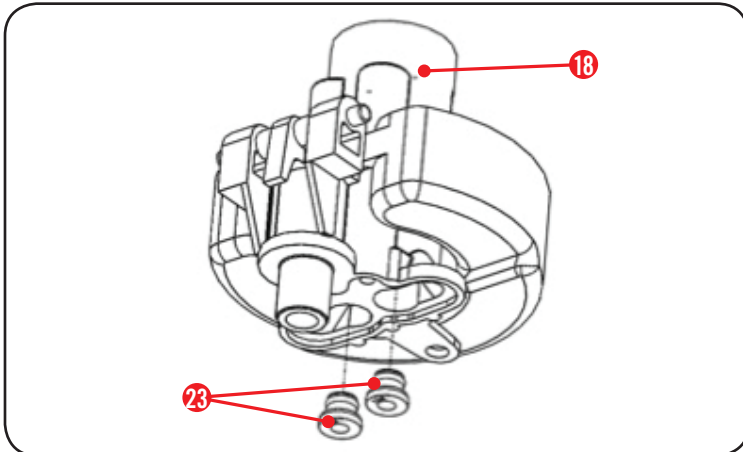

12. Insert high altitude jet assemblies (24) from bottom side of float assembly (18). Using a suitable rod such as a 1/8" pin punch, press jets until they are flush with float assembly surface.

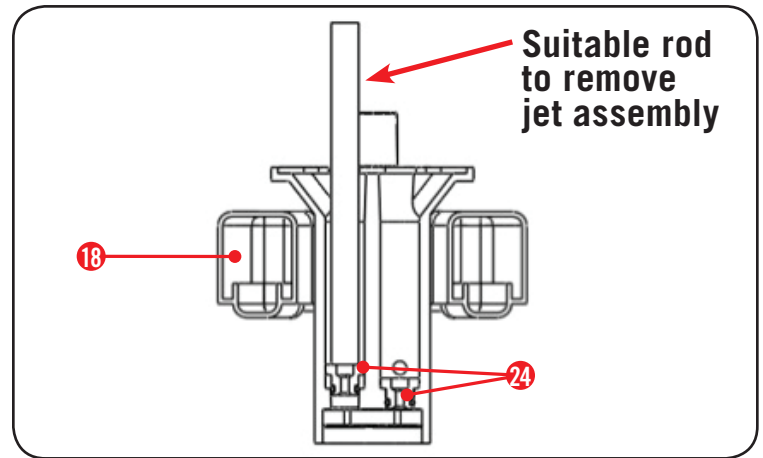

13. Install O-Ring (22) and gasket (25) into float assembly (18).

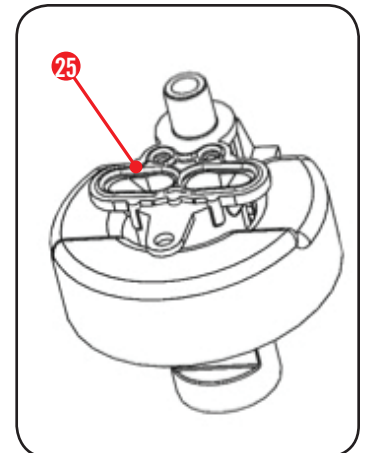
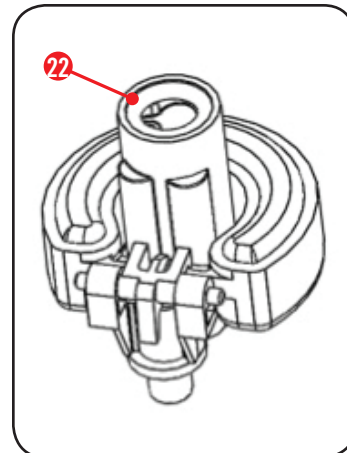

(Continued on page 4)

Operation at High Altitude Jet

14. Install O-Ring (26) to carburetor body.

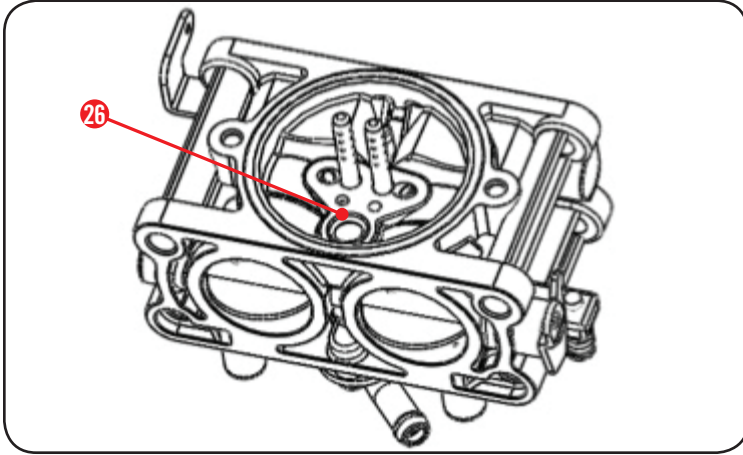

15. Install float assembly (18) to carburetor body.

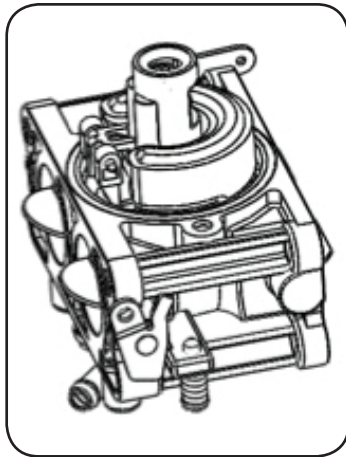
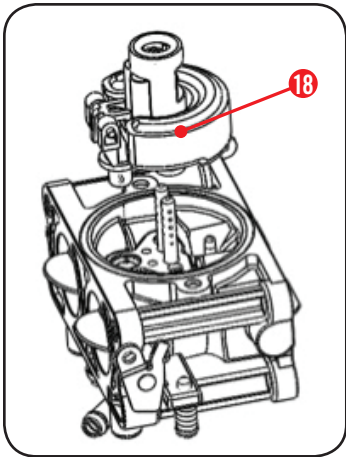

16. Install float bowl (17) to carburetor body. Tighten screws (16) to a torque of 3.9 Nm (35 in-lb).

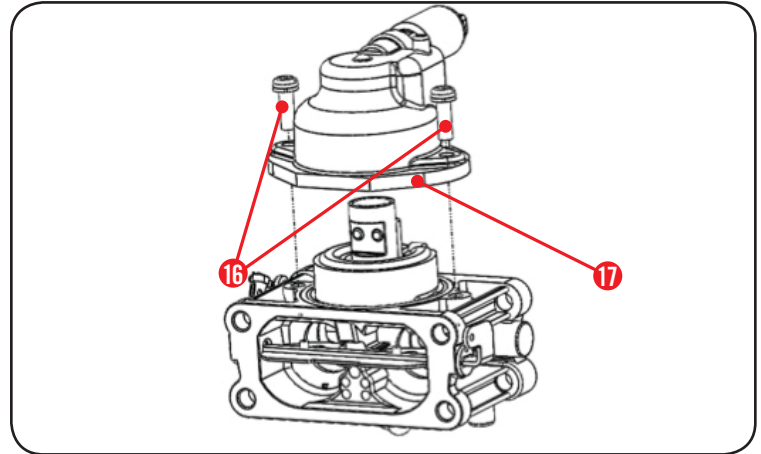

17. Re-assemble carburetor / float bowl assembly onto engine in reverse order of Steps 7 to 1. Torque carburetor / air clean elbow bolts (12) to 9 Nm (78 in-lbs).

If you have any questions, please contact us at:

Champion Power Equipment, Inc.

Customer Service

12039 Smith Ave.

Santa Fe Springs, CA 90670 USA

www.championpowerequipment.com

Technical Service

Mon – Fri 8:30 AM – 5:00 PM (PST/PDT)

Toll Free: 1-877-338-0999

tech@championpowerequipment.com