



OPERATOR'S MANUAL

MODEL #100470
ALUMINUM RAMP PAIR

MODEL #100471
STEEL RAMP PAIR



REGISTER YOUR PRODUCT ONLINE

at championpowerequipment.com

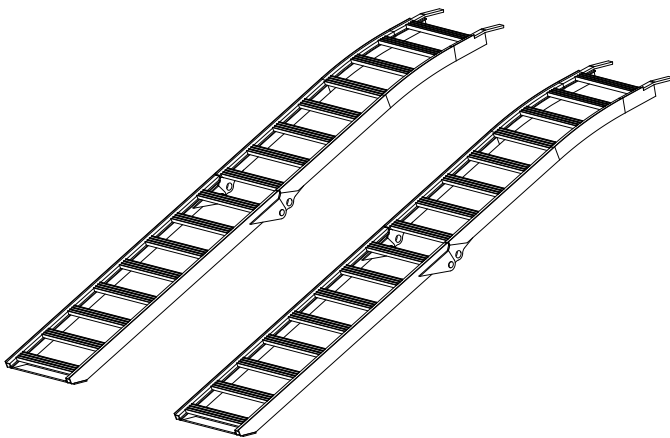

100470

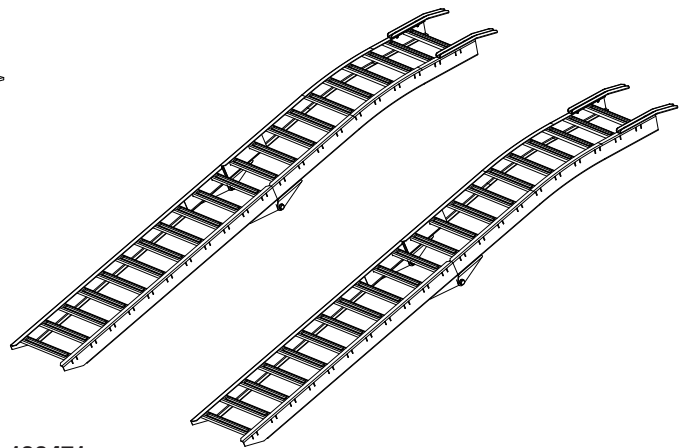

100471

⚠ DANGER

NEVER ride on any equipment up or down the loading ramp.

⚠ WARNING

To reduce the risk of injury, the user must read and understand the operator's manual before using this product. If you do not understand the warnings and instructions in the operator's manual, do not use this product.



1-877-338-0999

or visit championpowerequipment.com

SAVE THESE INSTRUCTIONS. This manual contains important safety precautions which should be read and understood before operating the product. Failure to do so could result in serious injury. This manual should remain with the product.

Specifications, descriptions and illustrations in this manual are as accurate as known at the time of publication, but are subject to change without notice.

TABLE OF CONTENTS

| | |
|---|----------|
| <u>Introduction</u> | 3 |
| <u>Safety Definitions</u> | 3 |
| <u>Important Safety Instructions</u> | 4 |
| <u>Safety Labels</u> | 5 |
| <u>Safety Symbols</u> | 6 |
| <u>Features</u> | 7 |
| <u>Parts Included</u> | 7 |
| <u>Assembly</u> | 7 |
| <u>Operation</u> | 8 |
| <u>Maintenance</u> | 9 |
| <u>Specifications</u> | 9 |
| <u>Aluminum Ramp – Model 100470</u> | 9 |
| <u>Steel Ramp – Model 100471</u> | 9 |
| <u>100470 Parts Diagram</u> | 10 |
| <u>100470 Parts List</u> | 10 |
| <u>100471 Parts Diagram</u> | 11 |
| <u>100471 Parts List</u> | 11 |

INTRODUCTION

Congratulations on your purchase of a Champion Power Equipment (CPE) product. CPE designs, builds, and supports all of our products to strict specifications and guidelines. With proper product knowledge, safe use, and regular maintenance, this product should bring years of satisfying service.

Every effort has been made to ensure the accuracy and completeness of the information in this manual at the time of publication, and we reserve the right to change, alter and/ or improve the product and this document at any time without prior notice.

CPE highly values how our products are designed, manufactured, operated, and serviced as well as providing safety to the operator and those around the generator. Therefore, it is **IMPORTANT** to review this product manual and other product materials thoroughly and be fully aware and knowledgeable of the assembly, operation, dangers and maintenance of the product before use. Fully familiarize yourself, and make sure others who plan on operating the product fully familiarize themselves too, with the proper safety and operation procedures before each use. Please always exercise common sense and always err on the side of caution when operating the product to ensure no accident, property damage, or injury occurs. We want you to continue to use and be satisfied with your CPE product for years to come.

When contacting CPE about parts and/or service, you will need to supply the complete model and serial numbers of your product. Transcribe the information found on your product's nameplate label to the table below

| |
|-----------------------------------|
| CPE TECHNICAL SUPPORT TEAM |
| 1-877-338-0999 |
| MODEL NUMBER |
| 100470 / 100471 |
| SERIAL NUMBER |
| |
| DATE OF PURCHASE |
| |
| PURCHASE LOCATION |
| |

SAFETY DEFINITIONS

The purpose of safety symbols is to attract your attention to possible dangers. The safety symbols, and their explanations, deserve your careful attention and understanding. The safety warnings do not by themselves eliminate any danger. The instructions or warnings they give are not substitutes for proper accident prevention measures.

DANGER

DANGER indicates a hazardous situation which, if not avoided, will result in death or serious injury.

WARNING

WARNING indicates a hazardous situation which, if not avoided, could result in death or serious injury.

CAUTION

CAUTION indicates a hazardous situation which, if not avoided, could result in minor or moderate injury.

NOTICE

NOTICE indicates information considered important, but not hazard-related (e.g., messages relating to property damage).

IMPORTANT SAFETY INSTRUCTIONS

- Read, understand and follow all instructions before attaching and using product.
- NEVER allow anyone unfamiliar with these instructions to use this product.
- Read, understand, follow and save all instructions provided by the manufacturer of the product(s) that this ramp will be used with.
- ALWAYS use on a level and stable surface.
- Extreme caution should be used when loading or unloading your equipment.
- Do not exceed the rated capacity of the ramp.
- Do not exceed the capacity of your loading surface (i.e. tailgate, bumper). If unknown, consult the manufacturer to find load capacities.
- NEVER ride on any equipment up or down the loading ramp.
- ALWAYS use and attach the straps provided.
- Straps must ALWAYS be attached to ramps and properly adjusted to prevent ramp from slipping off the loading surface.
- Straps must be secured tightly to limit any movement of the ramp while loading or unloading.
- If loading or unloading from a vehicle or trailer, the vehicle must be parked with emergency brake engaged and wheels are chocked, and engine is off.
- If loading or /unloading from a trailer, make sure the trailer is properly coupled to the tow vehicle and the wheels are chocked.
- NEVER stand in the path of equipment when loading or / unloading with the ramp and keep bystanders away from the ramps.
- Do not step in-between rungs, this may cause a person to slip and fall through and possibly result in serious bodily injury.
- Ramp surfaces slippery when wet or dirty, wipe dry and or clean before use.
- Ramps are intended for loading or unloading equipment onto a trailer or pickup truck.
- Do not use ramp sections as a ladder, bridge, scaffolding, or for any other use.
- Keep body parts completely clear of the hinge pinch areas at all times.
- Do not attempt to load or unload power equipment with engine running.
- Do not leave ramps unattended when attached.
- Do not cut, drill, weld or modify ramp sections. Any modifications to the ramp sections may cause them to become unstable and unsafe to use and will void your warranty.
- NEVER use ramp if there are broken, bent or worn parts.
- Remove ramp from loading position before moving vehicle or trailer.
- Failure to follow these warnings and instructions may result in property damage, serious bodily injury, and/or death.
- Save these instructions. Refer to them frequently and use them to instruct others who may use this product and if you loan someone these ramps, loan them these instructions also.

⚠ DANGER

Always attach strap. Strap must be attached and properly adjusted to prevent ramp from slipping off the loading surface.

100470

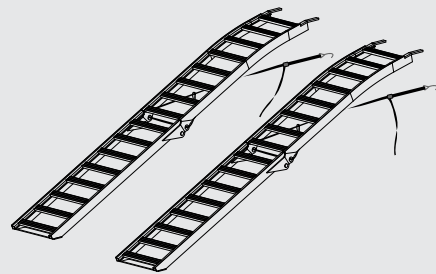

100471

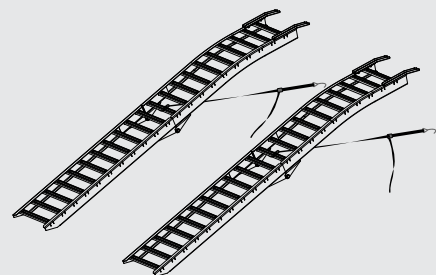

Safety Labels

These labels warn you of potential hazards that can cause serious injury. Read them carefully.

If a label comes off or becomes hard to read, contact Technical Support Team for possible replacement.

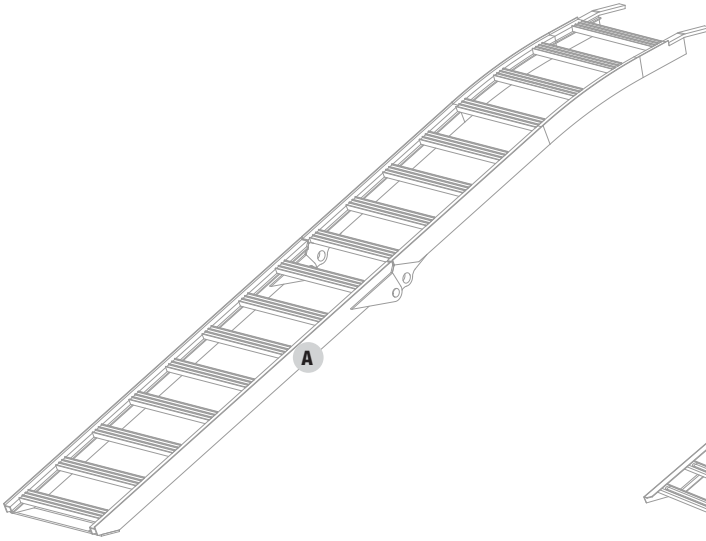

100470

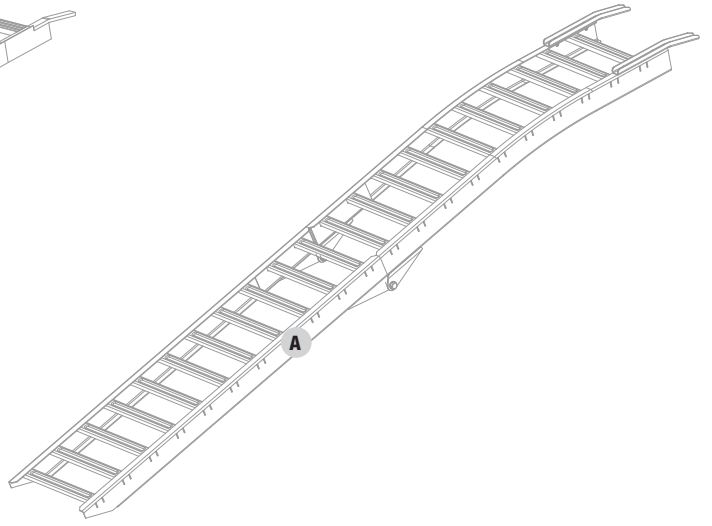



100471

| LABEL | | DESCRIPTION |
|-------|--|----------------|
| A | <p> To reduce the risk of injury, user must read and understand operator's manual before using this product. Para reducir el riesgo de lesiones, el usuario debe leer y comprender minuciosamente el manual antes de usar este producto. Pour réduire les risques de blessures, l'utilisateur doit lire et comprendre le guide d'utilisation avant d'utiliser ce produit. </p> <p> NEVER ride on any equipment or on down the loading ramp. NUNCA monte en ningún equipo subiendo y bajando la rampa. NE JAMAIS MONTE sur un équipement en haut ou en bas de la rampe de chargement. </p> <p> ALWAYS use and attach the straps provided. - Intended for loading or unloading equipment only. - Do not step in between ramps. - NEVER use any of them with broken, bent or worn parts. - Beware of pinch points at the hinges. - ALWAYS use on a level and stable surface. </p> <p> SIEMPRE use y fije las correas provistas. - Diseñadas para cargar y descargar equipo solamente. - No pisar en medio de los puentes. - NUNCA use la rampa si hay partes rotas, torcidas, o desgastadas. - Cuidado con puntos de pinchado en las bisagras. - SIEMPRE use en una superficie nivelada y estable. </p> <p> TOUJOURS utiliser et attacher les sangles fournies. - Destinés au chargement ou au déchargement de matériel uniquement. - Ne pas marcher entre les défilés. - NE JAMAIS utiliser la rampe si il y a des pièces cassées, tordues ou usées. - Attention aux points de pincement des charnières. - TOUJOURS utiliser sur une surface plane et stable. </p> <p style="text-align: right; font-size: small;">100-L-PR-A</p> | Safety Symbols |

Safety Symbols

Some of the following symbols may be used on this product. Please study them and learn their meaning. Proper interpretation of these symbols will allow you to more safely operate the product.

| SYMBOL | MEANING |
|---|---|
|  | Read Operator's Manual. To reduce the risk of injury, user must read and understand operator's manual before using this product. |
|  | Safety Alert. Precautions that involve your safety. |
|  | NEVER ride on any equipment up or down the loading ramp. |

FEATURES

Parts Included

- Ramps 2*
- Straps 2*

*Per model

100470

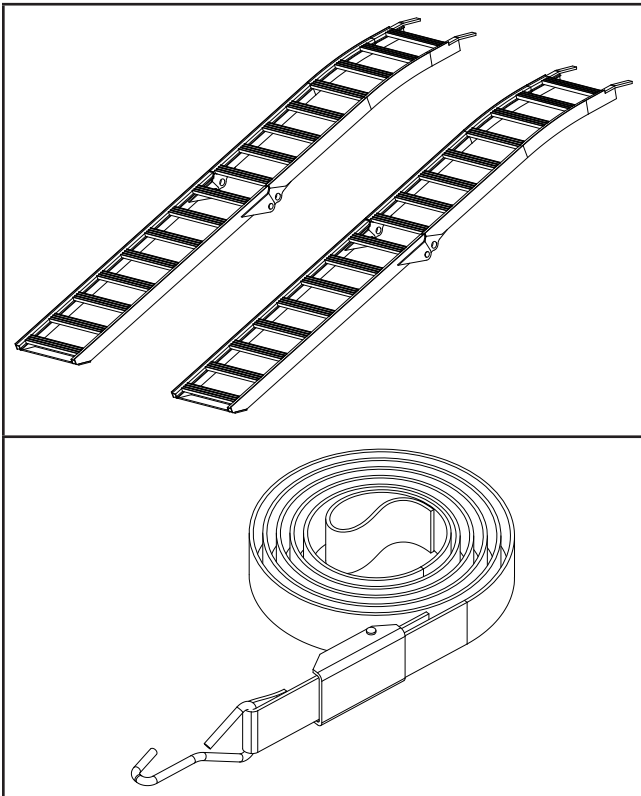

100471

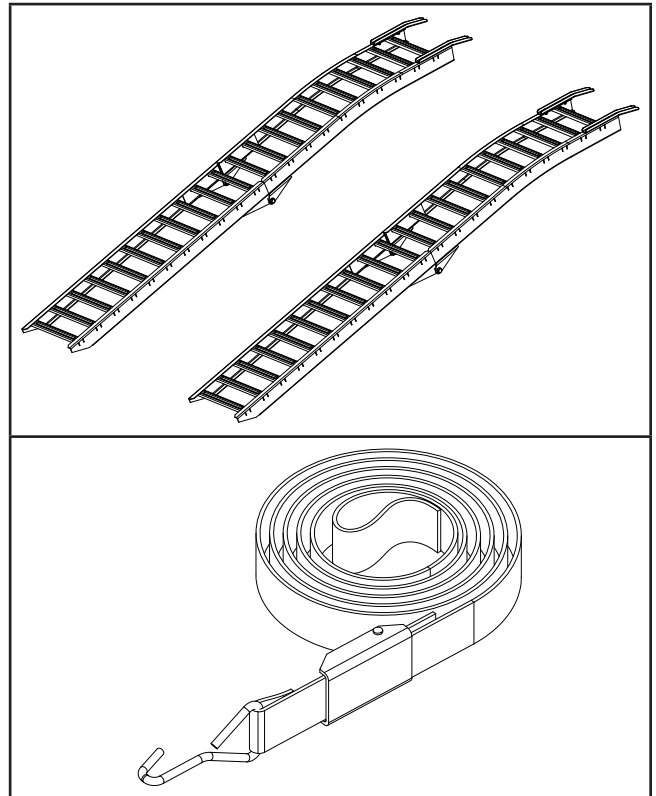

ASSEMBLY

No ramp assembly is required. The only initial assembly will be the setup of the straps for proper use.

OPERATION

1. Assure that your required maximum rated load capacity and maximum loading height conform to the chart and diagram.

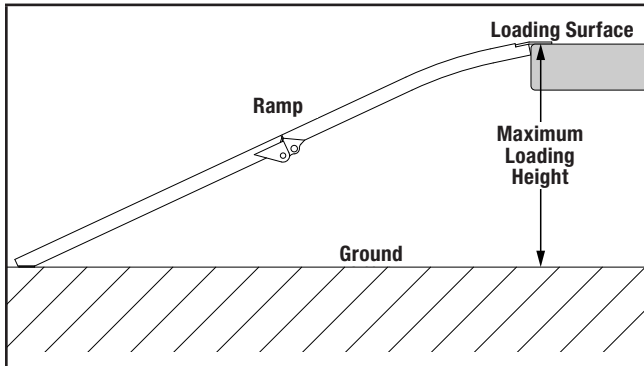

| MODEL | TYPE | MAXIMUM RATED LOAD CAPACITY | MAXIMUM LOADING HEIGHT |
|--------|----------|-----------------------------|------------------------|
| 100470 | Aluminum | 1000 lbs 454 kg | 30" / 76 cm |
| 100471 | Steel | 1500 lbs 680 kg | 30" / 76 cm |

Before each use check both straps for any fraying or excessive wear and make sure the strap cam locks are operating properly.

Before each use check the welds on the back of the ramp for any visual damage. Do not use if damaged in any way, failure to do so may result in damage to loading vehicle or equipment being loaded.

⚠ DANGER

Do not exceed maximum loading height.

2. Before using ramps, make sure the vehicle is parked with emergency brake engaged and wheels are chocked, and the engine is OFF to prevent any movement while loading or unloading equipment.

If loading or unloading from a trailer, make sure the trailer is properly coupled to the tow vehicle and the wheels are chocked.

🗨 NOTICE

When using ramps, always load or unload on a stable and level surface.

3. Center the ramps on loading surface with top plates placed completely and firmly on top of the loading surface.

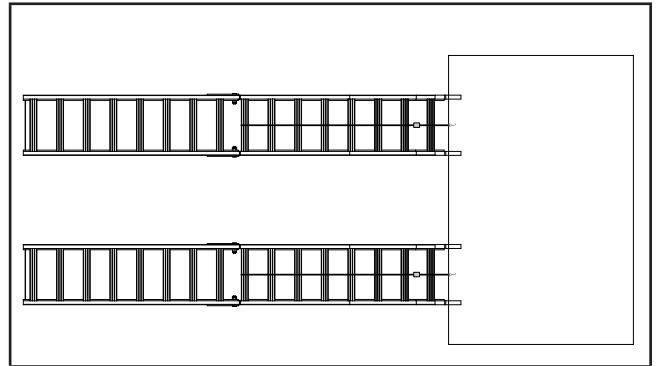

🗨 NOTICE

Movement of ramps may scratch mounting surface of loading vehicle or trailer.

🗨 NOTICE

Make sure ramp is open completely before positioning.

⚠ DANGER

Beware of pinch points at the hinges. Keep body parts away from pinch points.

4. Make sure that the ramps are aligned at the proper distance apart so that the tires of the equipment being loaded are centered on each of the ramp sections.

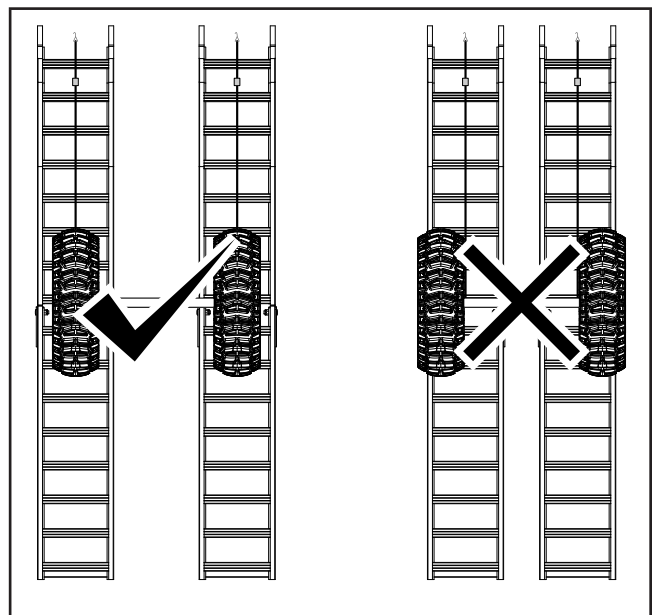

- Attach the strap from the underside of the ramp to a structural member of the loading vehicle (i.e. hitch, bumper, frame).

Depending on your model, you may have other options on how to attach the straps.

- Steel:** Feed looped end of strap around the center of the rung (centered on ramp) immediately above the hinge on the arched side of the ramp.

When attaching the straps to the loading vehicle, make sure that straps are in-line with the ramp section they are holding down.

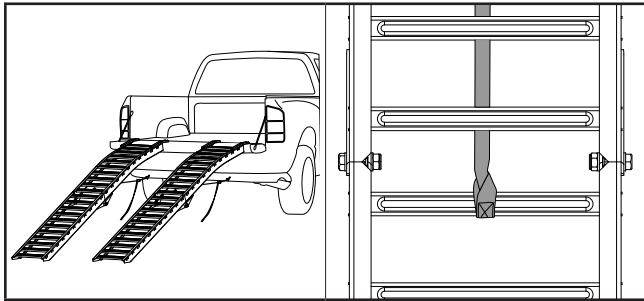

- Aluminum Option 1 (Recommended):** Using the holes provided near the hinge, feed the loop end of the strap through both sides of the ramp.

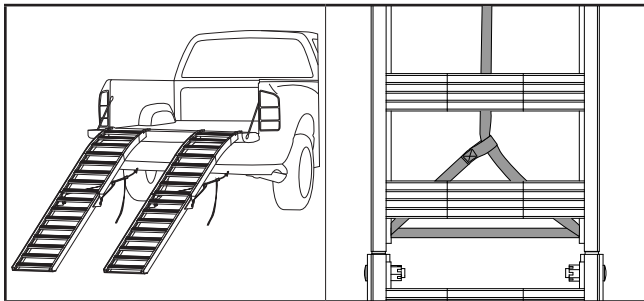

- Aluminum Option 2 (Alternate):** Feed looped end of strap around the center of the rung (centered on ramp) immediately above the hinge on the arched side of the ramp.

When attaching the straps to the loading vehicle, make sure that straps are in-line with the ramp section they are holding down.

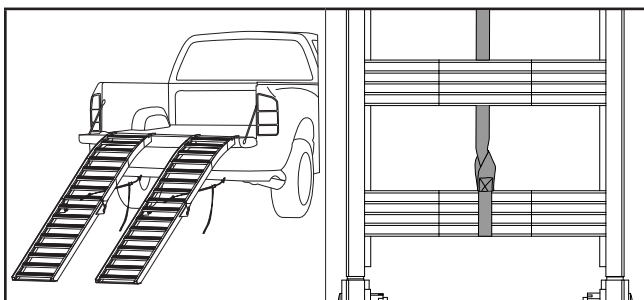

NOTICE

Straps must be secured tightly to the loading vehicle or trailer to limit any movement while loading or unloading.

- With the engine off, carefully roll or winch equipment up or down ramp.

⚠ DANGER

NEVER ride on any equipment up or down the loading ramp.

Failure to follow these instructions may result in serious injury.

MAINTENANCE

Routinely check the straps and the sewn connections of the straps for any fraying or excessive wear.

Before each use, make sure the strap cam lock is operating properly and is free of dirt, oil, grease and other contaminants that may build-up and cause the cam lock to work improperly and less effectively.

To provide maximum traction, keep ramp loading surfaces clean and free of dirt, oil, grease and other contaminants.

SPECIFICATIONS

Aluminum Ramp – Model 100470

Maximum Rated Load Capacity

| | |
|---------------------|---------------------|
| Ramp (single) | 500 lbs. (227 kg) |
| Ramp Pair (2 ramps) | 1,000 lbs. (454 kg) |

Dimensions

| | |
|--------|---------------|
| Length | 84" (213 cm) |
| Width | 12" (30.5 cm) |

Steel Ramp – Model 100471

Maximum Rated Load Capacity

| | |
|---------------------|---------------------|
| Ramp (single) | 750 lbs. (340 kg) |
| Ramp Pair (2 ramps) | 1,500 lbs. (680 kg) |

Dimensions

| | |
|--------|------------------|
| Length | 83.8" (212.8 cm) |
| Width | 11.8" (30 cm) |

100470 Parts Diagram

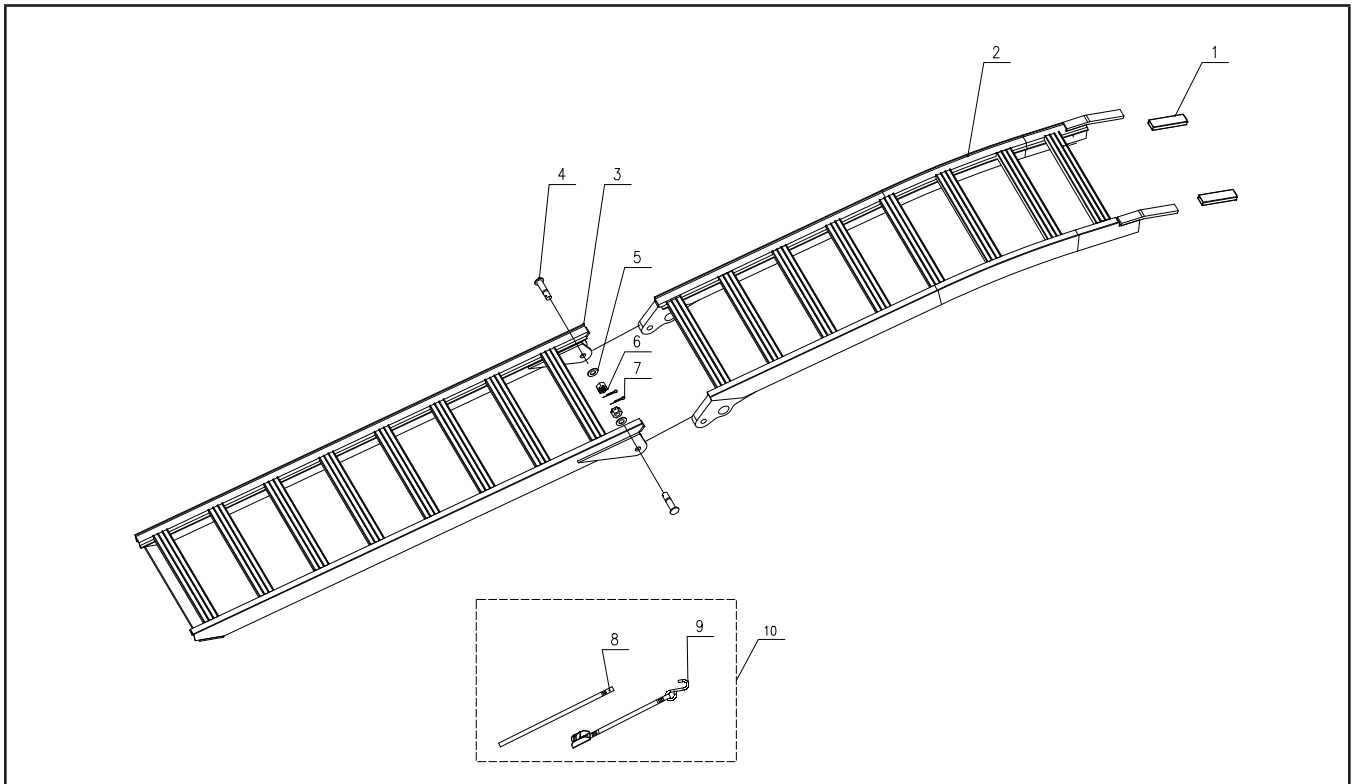

100470 Parts List

| # | Part Number | Description | Ramp Qty. (single) | Ramp Pair Qty. (2 ramps) |
|----|----------------|-------------------------------|-----------------------|-----------------------------|
| 1 | LVZDT.01 | Tailgate Brace Cap, Yellow | 2 | 4 |
| 2 | LVZDT.02 | Upper Ramp Assembly, Arched | 1 | 2 |
| 3 | LVZDT.03 | Lower Ramp Assembly, Straight | 1 | 2 |
| 4 | LVZDT.04 | Bolt M12×50 | 2 | 4 |
| 5 | G97.1-2002-13 | Flat Washer 2×Ø13×Ø24 | 2 | 4 |
| 6 | G6178-1986-M12 | Slotted Nut M12 | 2 | 4 |
| 7 | G91-2000-3-25 | Cotter Pin Ø3×25 | 2 | 4 |
| 8 | LVZDT.05 | Safety Strap 1 | 1 | 2 |
| 9 | LVZDT.06 | Safety Strap 2 | 1 | 2 |
| 10 | LVZDT.07 | Safety Strap Assembly | 1 | 2 |

100471 Parts Diagram

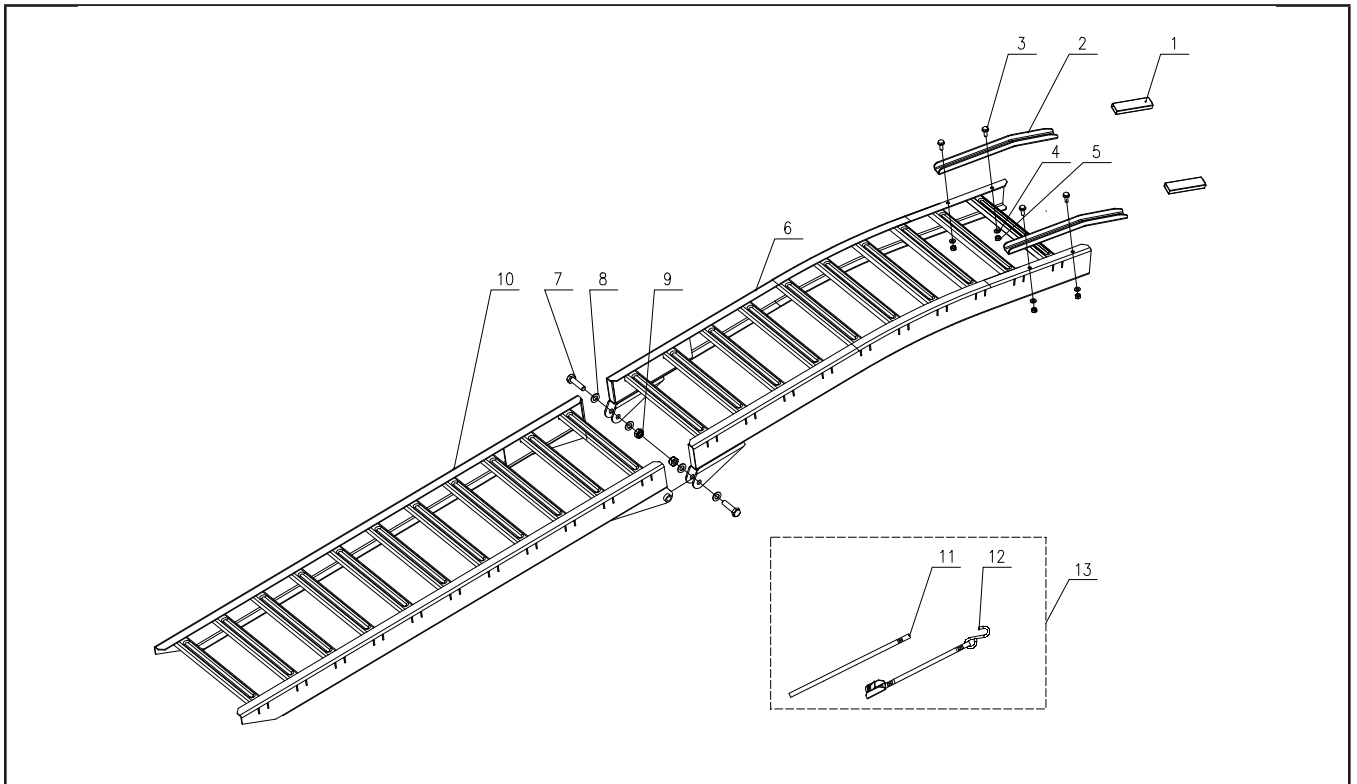

100471 Parts List

| # | Part Number | Description | Ramp Qty. (single) | Ramp Pair Qty. (2 ramps) |
|----|---------------------|-------------------------------|-----------------------|-----------------------------|
| 1 | 100471.01 | Tailgate Brace Cap, Yellow | 2 | 4 |
| 2 | 100471.02 | Tailgate Brace | 2 | 4 |
| 3 | G16674.1-2004-M6-16 | Hexagon Flange Bolt M6×16 | 4 | 8 |
| 4 | G95-2002-6 | Flat Washer Ø6 | 4 | 8 |
| 5 | G6182-2000-M6 | Lock Nut M6 | 4 | 8 |
| 6 | 100471.06 | Upper Ramp Assembly, Arched | 1 | 2 |
| 7 | G5780-2000-M10×45 | Hexagon Flange Bolt M10×45 | 2 | 4 |
| 8 | G95-2000-10 | Flat Washer Ø10 | 4 | 8 |
| 9 | G6182-2000-M10 | Lock Nut M10 | 2 | 4 |
| 10 | 100471.10 | Lower Ramp Assembly, Straight | 1 | 2 |
| 11 | LVZDT.05 | Strap 1 | 1 | 2 |
| 12 | LVZDT.06 | Strap 2 | 1 | 2 |
| 13 | LVZDT.07 | Safety Strap Assembly | 1 | 2 |

WARRANTY

CHAMPION POWER EQUIPMENT
1 YEAR LIMITED WARRANTY

Warranty Qualifications

To register your product for warranty and FREE lifetime call center technical support please visit:

<https://www.championpowerequipment.com/register>

To complete registration you will need to include a copy of the purchase receipt as proof of original purchase. Proof of purchase is required for warranty service. Please register within ten (10) days from date of purchase.

Repair/Replacement Warranty

CPE warrants to the original purchaser that the mechanical and electrical components will be free of defects in material and workmanship for a period of one year (parts and labor) from the original date of purchase and 90 days (parts and labor) for commercial and industrial use. Transportation charges on product submitted for repair or replacement under this warranty are the sole responsibility of the purchaser. This warranty only applies to the original purchaser and is not transferable.

Do Not Return The Unit To The Place Of Purchase

Contact CPE's Technical Service and CPE will troubleshoot any issue via phone or e-mail. If the problem is not corrected by this method, CPE will, at its option, authorize evaluation, repair or replacement of the defective part or component at a CPE Service Center. CPE will provide you with a case number for warranty service. Please keep it for future reference. Repairs or replacements without prior authorization, or at an unauthorized repair facility, will not be covered by this warranty.

Warranty Exclusions

This warranty does not cover the following repairs and equipment:

Normal Wear

Products with mechanical and electrical components need periodic parts and service to perform well. This warranty does not cover repair when normal use has exhausted the life of a part or the equipment as a whole.

Installation, Use and Maintenance

This warranty will not apply to parts and/or labor if the product is deemed to have been misused, neglected, involved in an accident, abused, loaded beyond the product's limits, modified, installed improperly or connected incorrectly to any electrical component. Normal maintenance is not covered by this warranty and is not required to be performed at a facility or by a person authorized by CPE.

Other Exclusions

This warranty excludes:

- Cosmetic defects such as paint, decals, etc.
- Wear items such as filter elements, o-rings, etc.
- Accessory parts such as starting batteries, and storage covers.
- Failures due to acts of God and other force majeure events beyond the manufacturer's control.
- Problems caused by parts that are not original Champion Power Equipment parts.

Limits of Implied Warranty and Consequential Damage

Champion Power Equipment disclaims any obligation to cover any loss of time, use of this product, freight, or any incidental or consequential claim by anyone from using this product. THIS WARRANTY IS IN LIEU OF ALL OTHER WARRANTIES, EXPRESS OR IMPLIED, INCLUDING WARRANTIES OF MERCHANTABILITY OR FITNESS FOR A PARTICULAR PURPOSE.

A unit provided as an exchange will be subject to the warranty of the original unit. The length of the warranty governing the exchanged unit will remain calculated by reference to the purchase date of the original unit.

This warranty gives you certain legal rights which may change from state to state or province to province. Your state or province may also have other rights you may be entitled to that are not listed within this warranty.

Contact Information

Address

Champion Power Equipment, Inc.
Customer Service
12039 Smith Ave.
Santa Fe Springs, CA 90670 USA
www.championpowerequipment.com

Customer Service

Mon – Fri 8:30 AM – 5:00 PM (PST/PDT)
Toll Free: 1-877-338-0999
info@championpowerequipment.com
Fax no.: 1-562-236-9429

Technical Service

Mon – Fri 8:30 AM – 5:00 PM (PST/PDT)
Toll Free: 1-877-338-0999
tech@championpowerequipment.com
24/7 Tech Support: 1-562-204-1188