

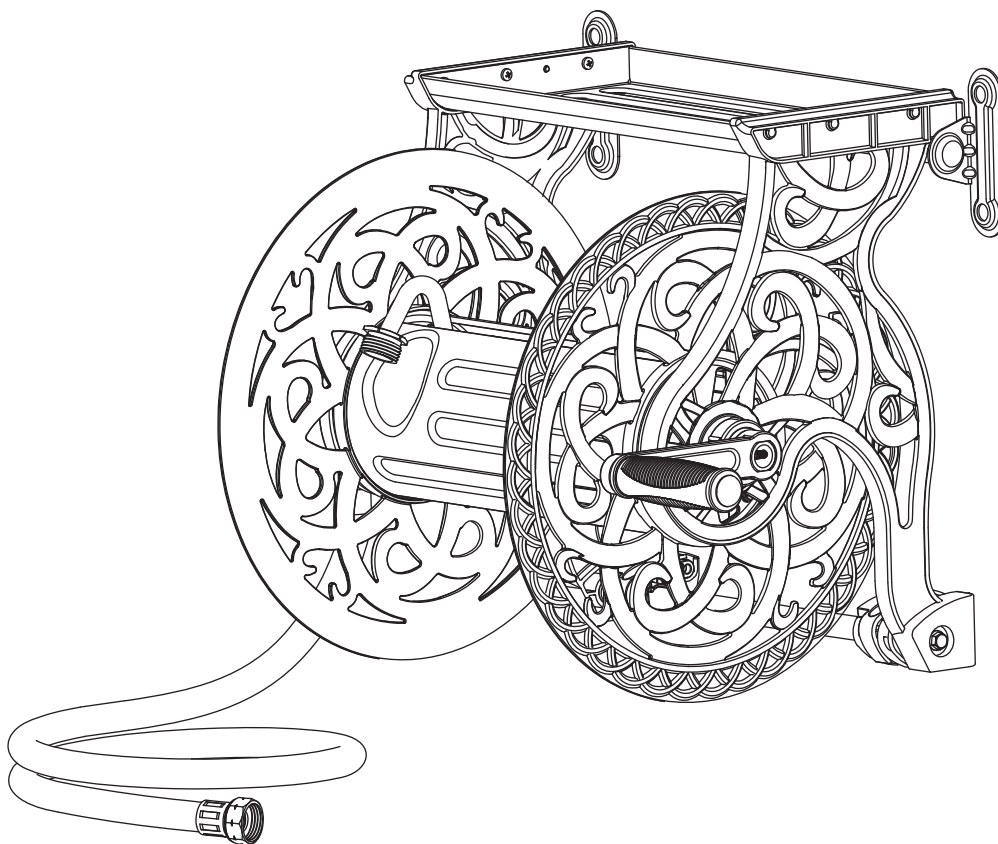

# OPERATOR'S MANUAL

MODEL #201055  
DETACHABLE HOSE REEL



 1-877-338-0999

or visit [championpowerequipment.com](http://championpowerequipment.com)

**SAVE THESE INSTRUCTIONS.** This manual contains important safety precautions which should be read and understood before operating the product. Failure to do so could result in serious injury. This manual should remain with the product.

Specifications, descriptions and illustrations in this manual are as accurate as known at the time of publication, but are subject to change without notice.

## TABLE OF CONTENTS

<b>Introduction</b>	<b>3</b>
<b>Safety Definitions</b>	<b>3</b>
<b>Important Safety Instructions</b>	<b>4</b>
Parts Included	5
Hardware Included	5
Recommended Tools (not included)	5
Replacements Parts	5
<b>Assembly</b>	<b>6</b>
Install Mounting Rail to Masonry Wall	6
Install Mounting Rail to a Stud Wall	6
Install Mounting Clips	7
Crank Assembly	7
Attach the Leader Hose	8
Moving or Storing the Hose Reel	8

## INTRODUCTION

Congratulations on your purchase of a Champion Power Equipment (CPE) product. CPE designs, builds, and supports all of our products to strict specifications and guidelines. With proper product knowledge, safe use, and regular maintenance, this product should bring years of satisfying service.

Every effort has been made to ensure the accuracy and completeness of the information in this manual at the time of publication, and we reserve the right to change, alter and/or improve the product and this document at any time without prior notice.

CPE highly values how our products are designed, manufactured, operated, and serviced as well as providing safety to the operator. Therefore, it is **IMPORTANT** to review this product manual and other product materials thoroughly and be fully aware and knowledgeable of the assembly, operation, dangers and maintenance of the product before use. Fully familiarize yourself, and make sure others who plan on operating the product fully familiarize themselves too, with the proper safety and operation procedures before each use. Please always exercise common sense and always err on the side of caution when operating the product to ensure no accident, property damage, or injury occurs. We want you to continue to use and be satisfied with your CPE product for years to come.

When contacting CPE about parts and/or service, you will need to supply the complete model and serial numbers of your product. Transcribe the information found on your product's nameplate label to the table below

CPE TECHNICAL SUPPORT TEAM
1-877-338-0999
MODEL NUMBER
201055
SERIAL NUMBER
DATE OF PURCHASE
PURCHASE LOCATION

## SAFETY DEFINITIONS

The purpose of safety symbols is to attract your attention to possible dangers. The safety symbols, and their explanations, deserve your careful attention and understanding. The safety warnings do not by themselves eliminate any danger. The instructions or warnings they give are not substitutes for proper accident prevention measures.

### DANGER

DANGER indicates a hazardous situation which, if not avoided, will result in death or serious injury.

### WARNING

WARNING indicates a hazardous situation which, if not avoided, could result in death or serious injury.

### CAUTION

CAUTION indicates a hazardous situation which, if not avoided, could result in minor or moderate injury.

### NOTICE

NOTICE indicates information considered important, but not hazard-related (e.g., messages relating to property damage).

## IMPORTANT SAFETY INSTRUCTIONS

### CAUTION

Read the entire guide before installation or use.

### WARNING

Connect only to water below 100 psi.

### CAUTION

Release pressure when not in use.

### WARNING

The coupling contains lead, a chemical known to the state of California to cause cancer and birth defects or other reproductive harm.

WASH HANDS after handling.

This hose is not for drinking water use.

### CAUTION

Please consider carefully the appropriate method to be used in mounting this hose reel. Hardware is included for your convenience, but may not be suitable for all mounting conditions. Some surfaces like vinyl siding or stucco may require special considerations or additional hardware. Improper mounting can cause personal injury or property damage. If you are unsure, contact a home improvement professional.

### WARNING

Water hose reel is not intended for use as a potable water source.

### NOTICE

If you have questions regarding your hose reel, we can help. Please call our help line at 1-877-338-0999

## Parts Included

2 m (6.5 ft.) leader hose .....	1
Decorative aluminum hose reel .....	1
Crank handle .....	1
Mounting clips .....	4
Mounting rails .....	2
Hardware pack .....	2
Owner's manual .....	1

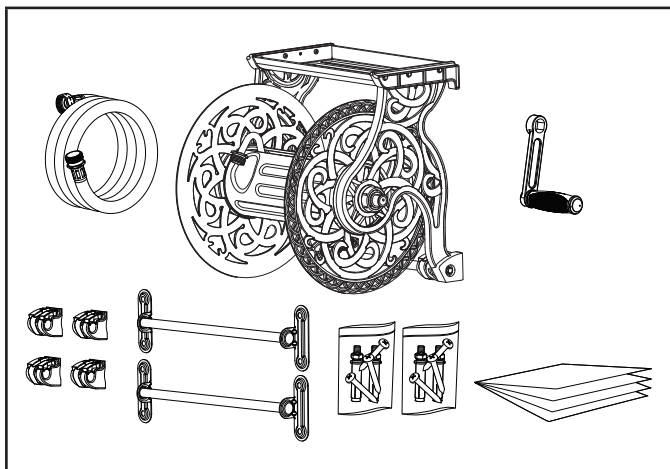

## Hardware Included

1. Crank screw – M5 x 15 .....	1
2. Masonry Anchor – OD 14mm - Threads M10 x 60 .....	8
3. Phillips Wood Screws – ST 4.8 x 38 .....	8
4. Lag screws – ST9.5 x 64 .....	8
5. Plastic anchors – OD 9.5~10mm - Length 40mm .....	8
6. Rubber O-ring .....	2*

\*Extra parts for leader hose

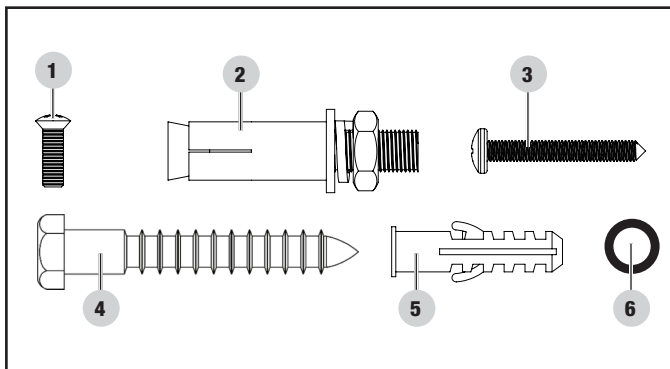

## Recommended Tools (not included)

1. Bubble level
2. Pen or pencil
3. Phillips-head screwdriver
4. Stud finder
5. Tape measure
6. Drill
7. Ø14 mm (35/64 in.) masonry drill bit
8. Ø6 mm (15/64 in.) drill bit
9. Ø10 mm (25/64 in.) drill bit
10. Adjustable wrench
11. Hammer

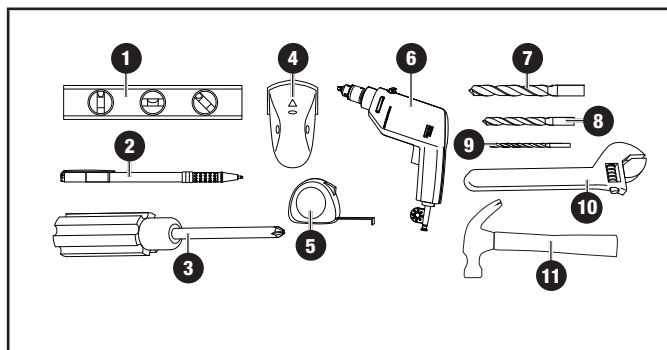

## Replacements Parts

For replacement parts, contact:

### Address

Champion Power Equipment, Inc.

Customer Service

12039 Smith Ave.

Santa Fe Springs, CA 90670 USA

[www.championpowerequipment.com](http://www.championpowerequipment.com)

### Customer Service

Toll Free: 1-877-338-0999

[info@championpowerequipment.com](mailto:info@championpowerequipment.com)

Fax no.: 1-562-236-9429

### Technical Service

Toll Free: 1-877-338-0999

[tech@championpowerequipment.com](mailto:tech@championpowerequipment.com)

24/7 Tech Support: 1-562-204-1188

## NOTICE

- 2 mounting rails, 4 mounting clips, and 2 hardware packs included.
- Allows you to have 2 mounting locations for your hose reel.

## ASSEMBLY

### NOTICE

Carefully remove all parts from the packing box. Locate all hardware and components before installation.

### NOTICE

Do not completely tighten bolts until assembly is completed. For easier assembly, we recommend that two people assemble this product.

### WARNING

Ensure there are no live electric wires or plumbing in the wall where you mount the hose reel.

### WARNING

Always use eye-protection when using power tools.

### Install Mounting Rail to Masonry Wall

1. Position the mounting rail on the wall at a convenient height.
2. Use a bubble level to ensure the mounting rail is horizontal.
3. Mark hole centre locations on the wall.

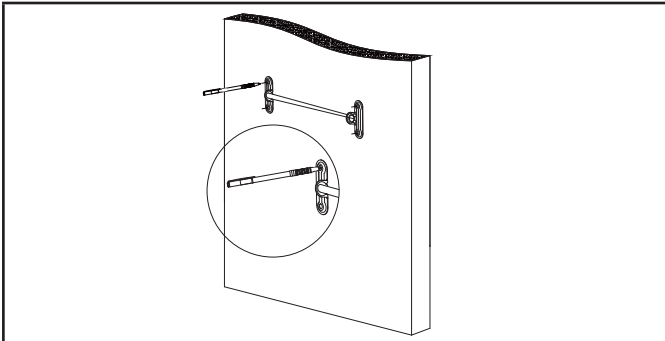

4. Using a 14 mm (35/64 in.) masonry drill bit, drill approximately 3.8 cm (1.5 in.) deep centered on the marks you made in step 3.

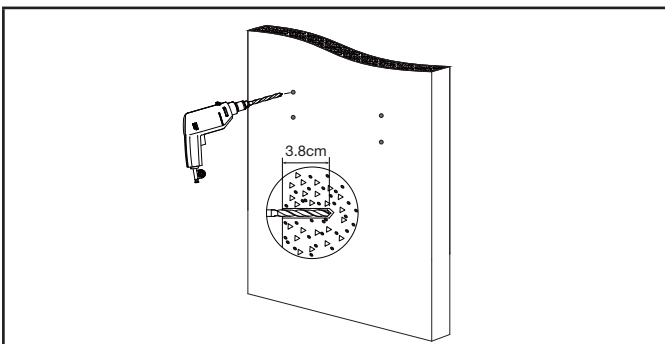

5. Using a hammer, lightly tap the masonry anchors into the holes, being careful not to damage them, until fully seated. Remove the nuts and washers.

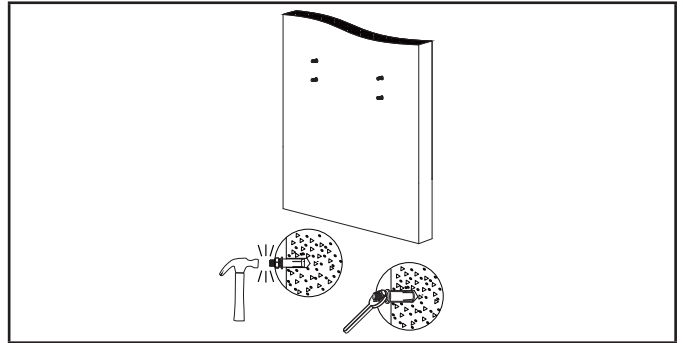

6. Hang the mounting rail onto the exposed anchors.
7. Replace the nuts and washers, tightening them with a wrench.

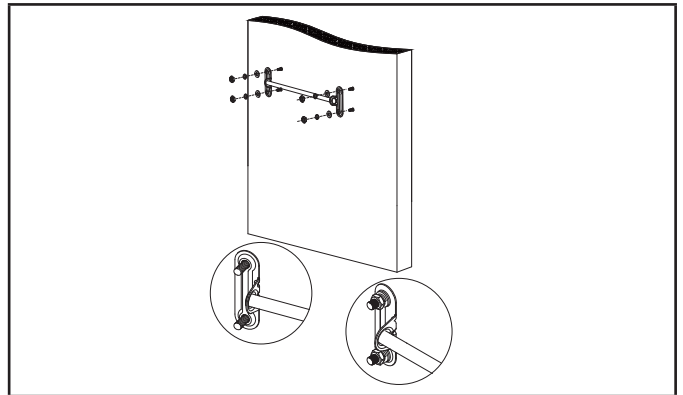

### Install Mounting Rail to a Stud Wall

1. Locate the studs using a stud finder.
2. Position the mounting rail on the wall at a convenient height.
3. Use a bubble level to ensure the mounting rail is horizontal.
4. Mark hole centre locations on the wall.

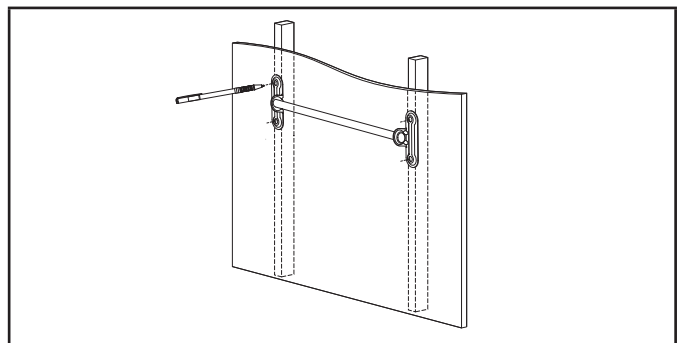

- Using a 6 mm (15/64 in.) drill bit, drill pilot holes approximately 6.4 cm (2.5 in.) deep centered on the marks you made in step 4.

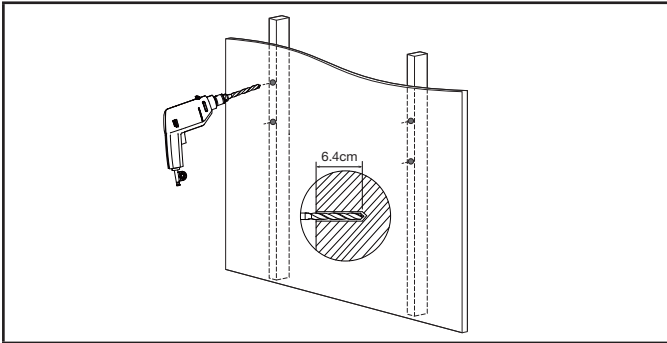

- Hang the mounting rail with the lag screws.

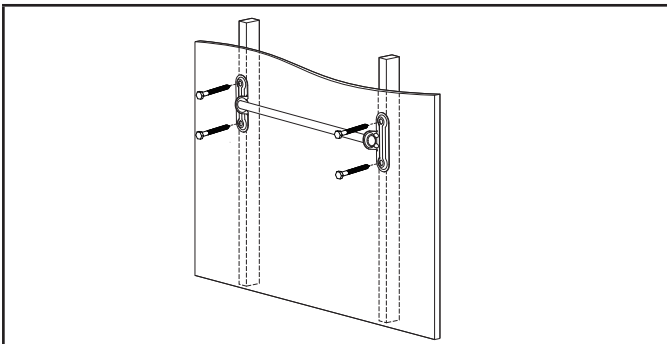

## Install Mounting Clips

- Position the mounting rail on the wall at a convenient height.
- Use a bubble level to ensure the mounting rail is horizontal.
- Mark hole centre locations on the wall.

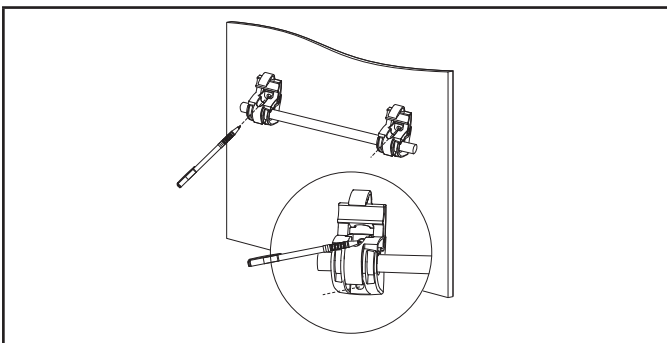

- Remove hose reel.

- Using a 10 mm (25/64 in.) drill bit, drill pilot holes approximately 4.1 cm (1 5/8 in.) deep centered on the marks you made in step 3.

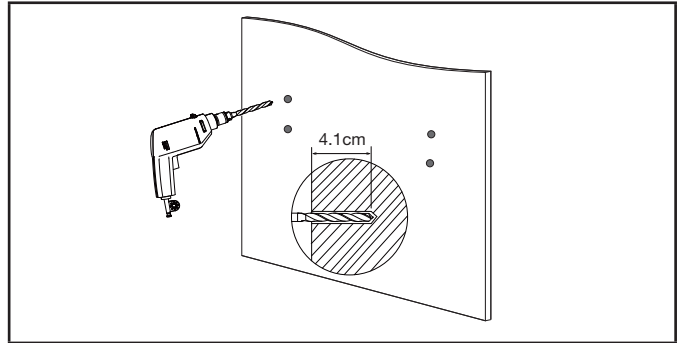

- Push plastic anchors into the holes.

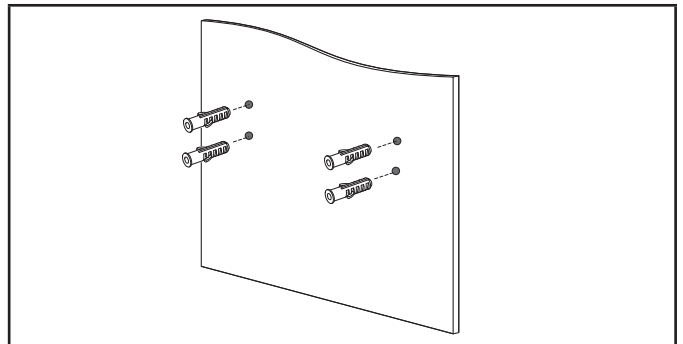

- Rehang hose reel.
- Drive screws into plastic anchors tightly with a screwdriver.

## Crank Assembly

- Assemble the crank on to the hose reel as shown.
- Secure with the crank screw.

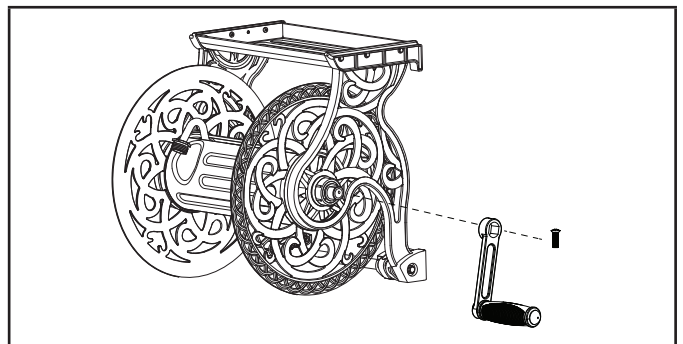

## Attach the Leader Hose

1. Inspect threaded female connector on hose reel, confirm that rubber O-ring is properly seated.

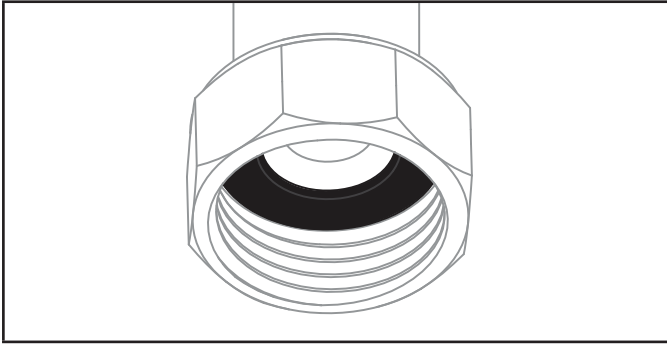

2. Connect threaded male connector end of leader hose to threaded female fitting on hose reel spool.
3. Tighten by hand until snug (clockwise).
4. With adjustable pliers or wrench tighten fully.

## Moving or Storing the Hose Reel

### NOTICE

Freezing temperatures can damage your hose and watering accessories. Always disconnect the connector hose and drain the water from the hose prior to freezing conditions.

### NOTICE

Prior to removing the hose reel for winter or moving the hose reel to a new location, always disconnect the connector hose and drain the water from the hoses before storing or moving.

### To remove hose reel from wall cradle:

1. Turn off water at house water spicket.
2. Unscrew leader hose from water spicket (leader hose connects the hose reel to the house spicket).
3. Unwind hose from hose reel.
4. Unscrew garden hose from hose reel.
5. Unlatch two lower clips.
6. Lift hose reel upward and out to remove from cradle system.

For re-installation, follow instructions in reverse.



# WARRANTY\*

CHAMPION POWER EQUIPMENT  
2 YEAR LIMITED WARRANTY

## Warranty Qualifications

To register your product for warranty and FREE lifetime call center technical support please visit:

<https://www.championpowerequipment.com/register>

To complete registration you will need to include a copy of the purchase receipt as proof of original purchase. Proof of purchase is required for warranty service. Please register within ten (10) days from date of purchase.

## Repair/Replacement Warranty

CPE warrants to the original purchaser that the mechanical and electrical components will be free of defects in material and workmanship for a period of two years (parts and labor) from the original date of purchase and 180 days (parts and labor) for commercial and industrial use. Transportation charges on product submitted for repair or replacement under this warranty are the sole responsibility of the purchaser. This warranty only applies to the original purchaser and is not transferable.

## Do Not Return The Unit To The Place Of Purchase

Contact CPE's Technical Service and CPE will troubleshoot any issue via phone or e-mail. If the problem is not corrected by this method, CPE will, at its option, authorize evaluation, repair or replacement of the defective part or component at a CPE Service Center. CPE will provide you with a case number for warranty service. Please keep it for future reference. Repairs or replacements without prior authorization, or at an unauthorized repair facility, will not be covered by this warranty.

## Warranty Exclusions

This warranty does not cover the following repairs and equipment:

### Normal Wear

Products with mechanical and electrical components need periodic parts and service to perform well. This warranty does not cover repair when normal use has exhausted the life of a part or the equipment as a whole.

### Installation, Use and Maintenance

This warranty will not apply to parts and/or labor if the product is deemed to have been misused, neglected, involved in an accident, abused, loaded beyond the product's limits, modified, installed improperly or connected incorrectly to any electrical component. Normal maintenance is not covered by this warranty and is not required to be performed at a facility or by a person authorized by CPE.

## Other Exclusions

This warranty excludes:

- Cosmetic defects such as paint, decals, etc.
- Wear items such as filter elements, o-rings, etc.
- Accessory parts such as storage covers.
- Failures due to acts of God and other force majeure events beyond the manufacturer's control.
- Problems caused by parts that are not original Champion Power Equipment parts.

## Limits of Implied Warranty and Consequential Damage

Champion Power Equipment disclaims any obligation to cover any loss of time, use of this product, freight, or any incidental or consequential claim by anyone from using this product. THIS WARRANTY IS IN LIEU OF ALL OTHER WARRANTIES, EXPRESS OR IMPLIED, INCLUDING WARRANTIES OF MERCHANTABILITY OR FITNESS FOR A PARTICULAR PURPOSE.

A unit provided as an exchange will be subject to the warranty of the original unit. The length of the warranty governing the exchanged unit will remain calculated by reference to the purchase date of the original unit.

This warranty gives you certain legal rights which may change from state to state or province to province. Your state or province may also have other rights you may be entitled to that are not listed within this warranty.

## Contact Information

### Address

Champion Power Equipment, Inc.  
12039 Smith Ave.  
Santa Fe Springs, CA 90670 USA  
[www.championpowerequipment.com](http://www.championpowerequipment.com)

### Customer Service

Toll Free: 1-877-338-0999  
[info@championpowerequipment.com](mailto:info@championpowerequipment.com)  
Fax no.: 1-562-236-9429

### Technical Service

Toll Free: 1-877-338-0999  
[tech@championpowerequipment.com](mailto:tech@championpowerequipment.com)  
24/7 Tech Support: 1-562-204-1188