



OPERATOR'S MANUAL

MODEL #100736
12 FT. PROPANE (LPG)
HOSE EXTENSION KIT



or visit championpowerequipment.com

SAVE THESE INSTRUCTIONS. This manual contains important safety precautions which should be read and understood before operating the product. Failure to do so could result in serious injury. This manual should remain with the product.

Specifications, descriptions and illustrations in this manual are as accurate as known at the time of publication, but are subject to change without notice.

**TAKE IT
OUTSIDE™**



CARBON MONOXIDE KILLS

CARBON MONOXIDE SAFETY: THE BIG PICTURE

As the only safe way to use a portable generator, taking your generator outside is absolutely mandatory to keep your family safe from carbon monoxide. But there's even more you can do. By educating yourself about all carbon monoxide risks, you'll be better prepared to protect your family from this colorless, odorless threat.



**ALWAYS READ
THE OPERATOR'S
MANUAL FIRST**



KNOW THE SYMPTOMS

- Headache
- Nausea
- Shortness of breath
- Dizziness
- Fatigue

**STAY ALERT WITH CARBON
MONOXIDE DETECTORS**

**KEEP IT OUTSIDE AND AWAY FROM
DOORS, WINDOWS, AND GARAGES**

**IF YOU FEEL SYMPTOMS,
LEAVE RIGHT AWAY**

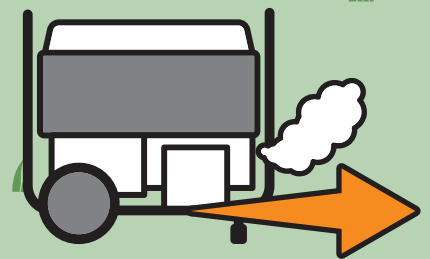

**POINT FUMES AWAY FROM
NEARBY PEOPLE**

www.TakeYourGeneratorOutside.com

TABLE OF CONTENTS

Introduction	4
Safety Definitions	4
Parts Included	5
Assembly	6
Specifications	7
Warranty*	8
Warranty Qualifications	8
Repair/Replacement Warranty	8
Do Not Return The Unit To The Place Of Purchase	8
Warranty Exclusions	8
Other Exclusions	8
Limits of Implied Warranty and Consequential Damage	8
Contact Information	8

INTRODUCTION

Congratulations on your purchase of a Champion Power Equipment (CPE) product. CPE designs, builds, and supports all of our products to strict specifications and guidelines. With proper product knowledge, safe use, and regular maintenance, this product should bring years of satisfying service.

Every effort has been made to ensure the accuracy and completeness of the information in this manual at the time of publication, and we reserve the right to change, alter and/or improve the product and this document at any time without prior notice.

CPE highly values how our products are designed, manufactured, operated, and serviced as well as providing safety to the operator and those around the generator. Therefore, it is **IMPORTANT** to review this product manual and other product materials thoroughly and be fully aware and knowledgeable of the assembly, operation, dangers and maintenance of the product before use. Fully familiarize yourself, and make sure others who plan on operating the product fully familiarize themselves too, with the proper safety and operation procedures before each use. Please always exercise common sense and always err on the side of caution when operating the product to ensure no accident, property damage, or injury occurs. We want you to continue to use and be satisfied with your CPE product for years to come.

When contacting CPE about parts and/or service, you will need to supply the complete model and serial numbers of your product. Transcribe the information found on your product's nameplate label to the table below

CPE TECHNICAL SUPPORT TEAM
1-877-338-0999
MODEL NUMBER
100736
SERIAL NUMBER
DATE OF PURCHASE
PURCHASE LOCATION

SAFETY DEFINITIONS

The purpose of safety symbols is to attract your attention to possible dangers. The safety symbols, and their explanations, deserve your careful attention and understanding. The safety warnings do not by themselves eliminate any danger. The instructions or warnings they give are not substitutes for proper accident prevention measures.

DANGER

DANGER indicates a hazardous situation which, if not avoided, will result in death or serious injury.

WARNING

WARNING indicates a hazardous situation which, if not avoided, could result in death or serious injury.

CAUTION

CAUTION indicates a hazardous situation which, if not avoided, could result in minor or moderate injury.

NOTICE

NOTICE indicates information considered important, but not hazard-related (e.g., messages relating to property damage).

PARTS INCLUDED

1/4 in. (6.4 mm) x 12 ft. (3.7m) Propane (LPG)

Hose Extension 1

Holding Strap (Model 100690) 1

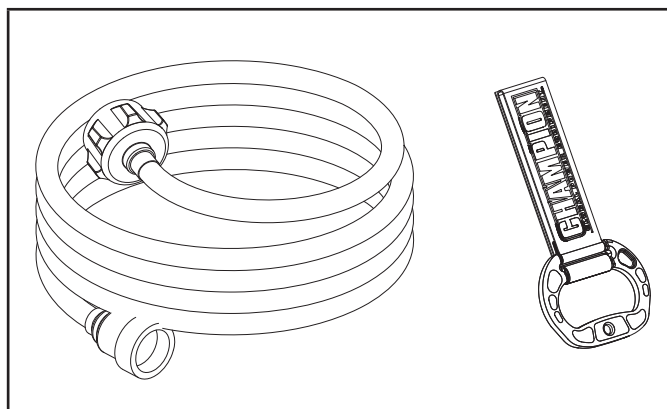

ASSEMBLY

⚠ DANGER

Failure to comply with the following instructions may result in an explosion or fire that may cause property damage, serious bodily injury, or DEATH:

NEVER place the LPG (liquefied petroleum gas) connector hose OR LPG cylinder tank in the path of the muffler exhaust gas stream of the generator during engine operation.

NEVER use an LPG connector hose, LPG regulator or LPG cylinder tank that is cut, torn, broken or damaged.

NEVER use LPG near sparks, open flames, pilot lights, muffler exhaust heat and other sources of high heat or electrical ignition.

NEVER use a damaged LPG connector hose or regulator assembly. Replace damaged components.

⚠ WARNING

ALWAYS make sure LPG cylinder valve is in the full OFF position. Turn LPG cylinder valve clockwise until fully seated.

ALWAYS inspect LPG connector hose and regulator assembly for damage before use.

ALWAYS insert or tighten hose assembly onto generator. When using a threaded coupling, DO NOT OVERTIGHTEN.

ALWAYS tighten LPG connector assembly by hand, use of tools may damage coupling resulting in a leaky hazardous condition.

To check for leaks, use a soapy water mixture to verify all connections prior to starting the generator. DO NOT START GENERATOR IF SOAPY BUBBLES ARE PRESENT INDICATING LEAKS. RECHECK CONNECTION TIGHTNESS, REPEAT SOAPY WATER MIXTURE ON CONNECTION FITTINGS.

OPEN LPG cylinder valve by turning counterclockwise to its fully open position to operate generator.

ALWAYS close the LPG cylinder valve clockwise when not in use.

THIS LPG CONNECTOR HOSE ASSEMBLY CANNOT BE USED FOR OTHER APPLIANCES.

Connecting the propane (LPG) hose:

1. Ensure the generator is off and the LPG cylinder valve is shut and turned fully clockwise to the off position.

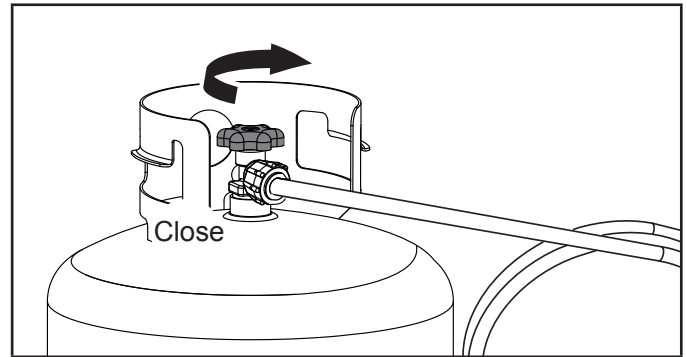

2. Attach the male end of the extension hose to the female end of the LPG hose and regulator assembly by turning the assembly side connector counter clockwise to tighten.

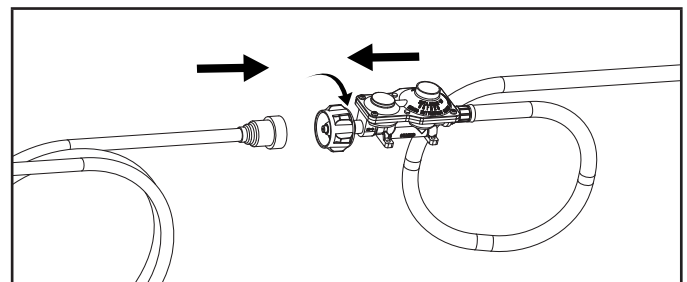

3. Attach the female end of the extension hose to the LPG tank by turning the connector clockwise to tighten.

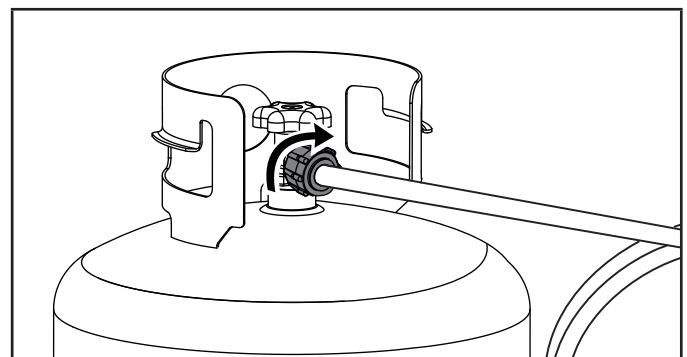

4. Reference your generator's instruction manual to correctly attach the LPG hose and regulator assembly to your generator.

5. Fully open the fuel valve on the LPG cylinder valve by turning counter clockwise to turn on the gas supply. Check all connections for leaks by wetting the fittings with a solution of soap and water. Bubbles which appear or bubbles which grow indicate that a leak exists. If a leak exists, immediately close the LPG cylinder valve. Fix the leak. Turn the cylinder valve back on and recheck the fitting with the soap and water solution. If the leak continues, turn the cylinder valve off and do not use the generator and contact a qualified technician.
6. Reference your generator's instruction manual for starting instructions.

SPECIFICATIONS

Female Connection	Black ACME (Type 1)
Male Connection	ACME (Type 1)
Length	12ft (3.7m)
Diameter	0.25" (6.4mm)

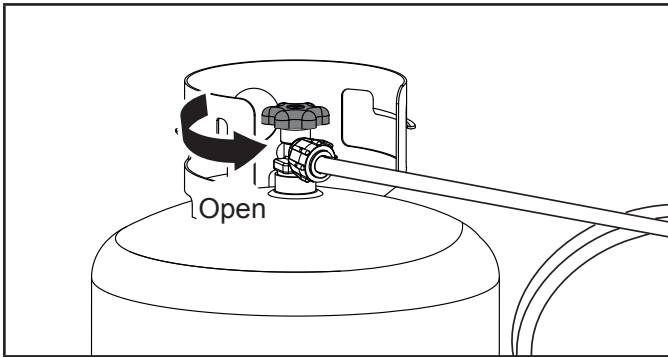

Disconnecting the propane (LPG) hose:

1. Turn the LPG cylinder valve clockwise until it stops to shut off the gas supply. Reference your generator's instruction manual to turn your generator off.

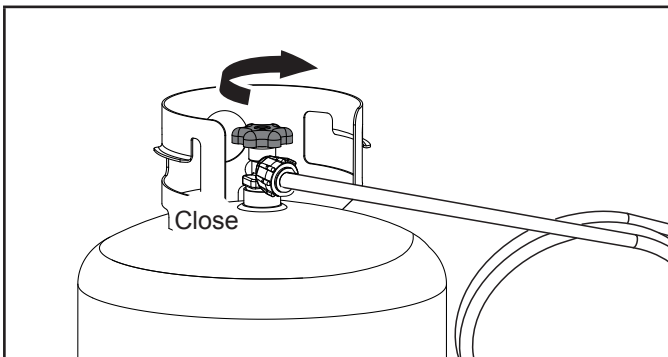

2. Reverse the tightening directions in steps 2 and 3 above to disassemble.
3. Reference your generator's instruction manual to disconnect the LPG hose and regulator assembly from your generator.
4. Store the assembly and extension hose away from sunlight in a safe and dry location when not in use. Always ensure your generator is fully off and (if applicable) the dial, engine switch, and battery switch are all set to the off position.

WARRANTY*

CHAMPION POWER EQUIPMENT

1 YEAR LIMITED WARRANTY

Warranty Qualifications

To register your product for warranty and FREE lifetime call center technical support please visit:

<https://www.championpowerequipment.com/register>

To complete registration you will need to include a copy of the purchase receipt as proof of original purchase. Proof of purchase is required for warranty service. Please register within ten (10) days from date of purchase.

Repair/Replacement Warranty

CPE warrants to the original purchaser that the mechanical and electrical components will be free of defects in material and workmanship for a period of one year (parts and labor) from the original date of purchase and 90 days (parts and labor) for commercial and industrial use. Transportation charges on product submitted for repair or replacement under this warranty are the sole responsibility of the purchaser. This warranty only applies to the original purchaser and is not transferable.

Do Not Return The Unit To The Place Of Purchase

Contact CPE's Technical Service and CPE will troubleshoot any issue via phone or e-mail. If the problem is not corrected by this method, CPE will, at its option, authorize evaluation, repair or replacement of the defective part or component at a CPE Service Center. CPE will provide you with a case number for warranty service. Please keep it for future reference. Repairs or replacements without prior authorization, or at an unauthorized repair facility, will not be covered by this warranty.

Warranty Exclusions

This warranty does not cover the following repairs and equipment:

Normal Wear

Products with mechanical and electrical components need periodic parts and service to perform well. This warranty does not cover repair when normal use has exhausted the life of a part or the equipment as a whole.

Installation, Use and Maintenance

This warranty will not apply to parts and/or labor if the product is deemed to have been misused, neglected, involved in an accident, abused, loaded beyond the product's limits, modified, installed improperly or connected incorrectly to any electrical component. Normal maintenance is not covered by this warranty and is not required to be performed at a facility or by a person authorized by CPE.

Other Exclusions

This warranty excludes:

- Cosmetic defects such as paint, decals, etc.
- Wear items such as filter elements, o-rings, etc.
- Accessory parts such as starting batteries, and storage covers.
- Failures due to acts of God and other force majeure events beyond the manufacturer's control.
- Problems caused by parts that are not original Champion Power Equipment parts.

Limits of Implied Warranty and Consequential Damage

Champion Power Equipment disclaims any obligation to cover any loss of time, use of this product, freight, or any incidental or consequential claim by anyone from using this product. THIS WARRANTY IS IN LIEU OF ALL OTHER WARRANTIES, EXPRESS OR IMPLIED, INCLUDING WARRANTIES OF MERCHANTABILITY OR FITNESS FOR A PARTICULAR PURPOSE.

A unit provided as an exchange will be subject to the warranty of the original unit. The length of the warranty governing the exchanged unit will remain calculated by reference to the purchase date of the original unit.

This warranty gives you certain legal rights which may change from state to state or province to province. Your state or province may also have other rights you may be entitled to that are not listed within this warranty.

Contact Information

Address

Champion Power Equipment, Inc.
6370 S Pioneer Way, Unit 101
Las Vegas, NV 89113 USA
www.championpowerequipment.com

Customer Service

Toll Free: 1-877-338-0999
info@championpowerequipment.com
Fax no.: 1-562-236-9429

Technical Service

Toll Free: 1-877-338-0999
tech@championpowerequipment.com
24/7 Tech Support: 1-562-204-1188